

Three Bedroom Split-Level Maisonette located
close to Walthamstow Central Station!

CHURCHILL
estates



Gaitskell House, Walthamstow, E17 3DD
£1,350 Per Calendar Month



To view call **0208 503 6060**
Email walthamstow@churchill-estates.co.uk



Available Late September 2022 - FURNISHED - SPLIT LEVEL - THREE DOUBLE BEDROOMS - LONG TERM

Churchill Estates are pleased to offer this Three Bedroom Split-Level Flat situated close to Walthamstow Central Station, Local Bus Routes and Schools.

The property benefits from gas central heating, security entryphone system, private balcony and double glazing.

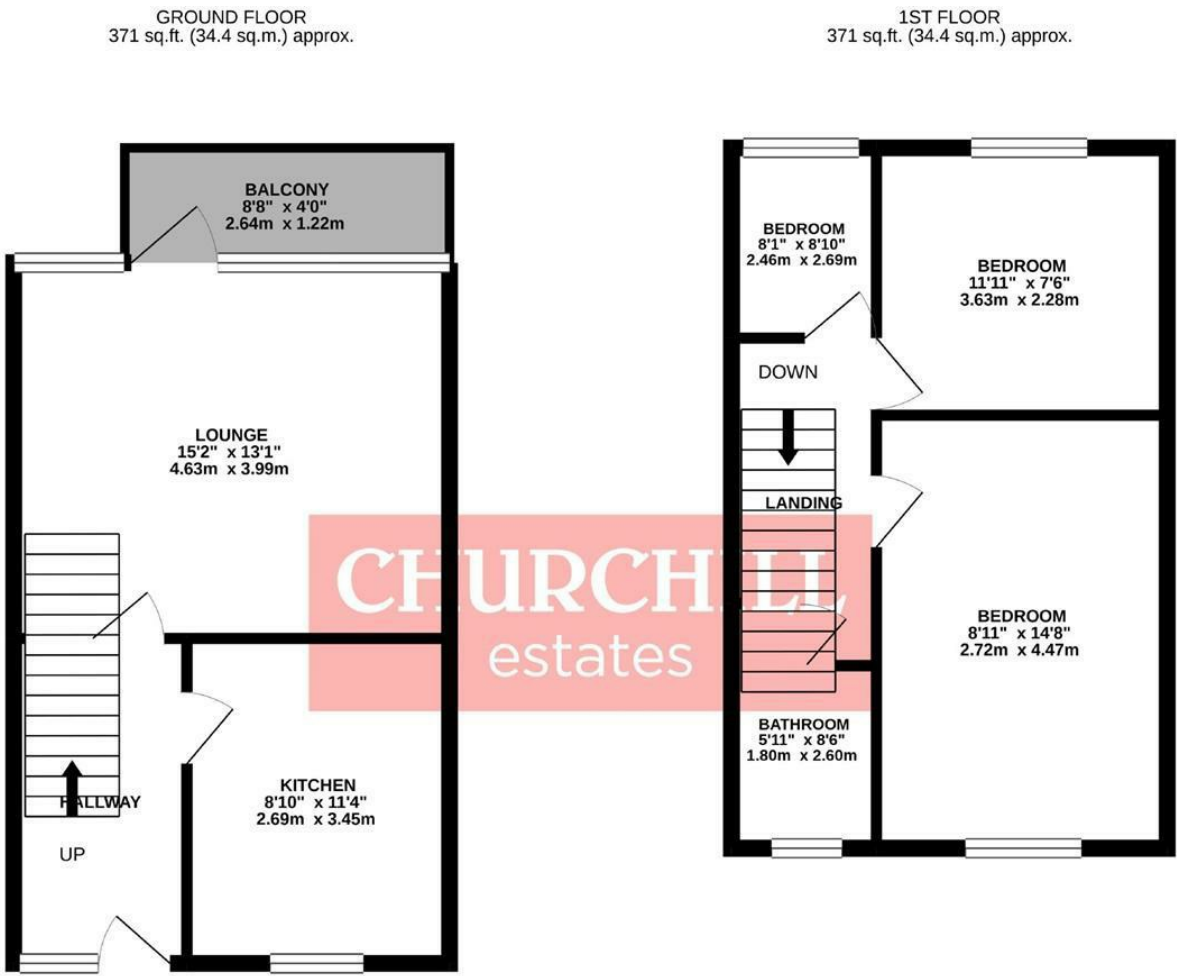

TOTAL FLOOR AREA: 742 sq.ft. (68.9 sq.m.) approx.
Whilst every attempt has been made to ensure the accuracy of the floorplan contained here, measurements of doors, windows, rooms and any other items are approximate and no responsibility is taken for any error, omission or mis-statement. This plan is for illustrative purposes only and should be used as such by any prospective purchaser. The services, systems and appliances shown have not been tested and no guarantee as to their operability or efficiency can be given.
Made with Metropix ©2020

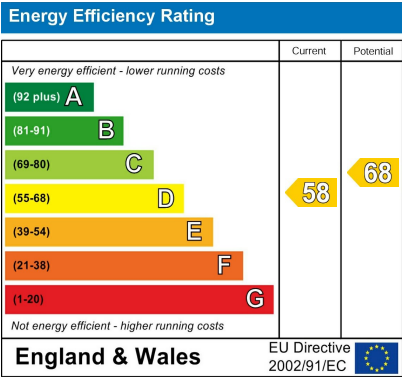

Council Tax Band B

EPC D rating

12 Month Minimum Term Tenancy (6 Month Break Clause may be available)

£1,557.00 - 5 Week security deposit

The Agent has not tested any apparatus, equipment, fixtures and fittings or services and so cannot verify that they are in working order or fit for the purpose. A buyer is advised to obtain verification from their solicitor or surveyor.
References to the tenure of a property are based on information supplied by the seller. The agent has not had the sight of the title documents. A buyer is advised to obtain verification from their solicitors.

CHURCHILL
estates

To view call **0208 503 6060**
Email walthamstow@churchill-estates.co.uk